

KOSTRZEWA®
Ogrzewanie i wentylacja



Instrukcja montażu zbiornika 290L

Installation manual of the tank 290L



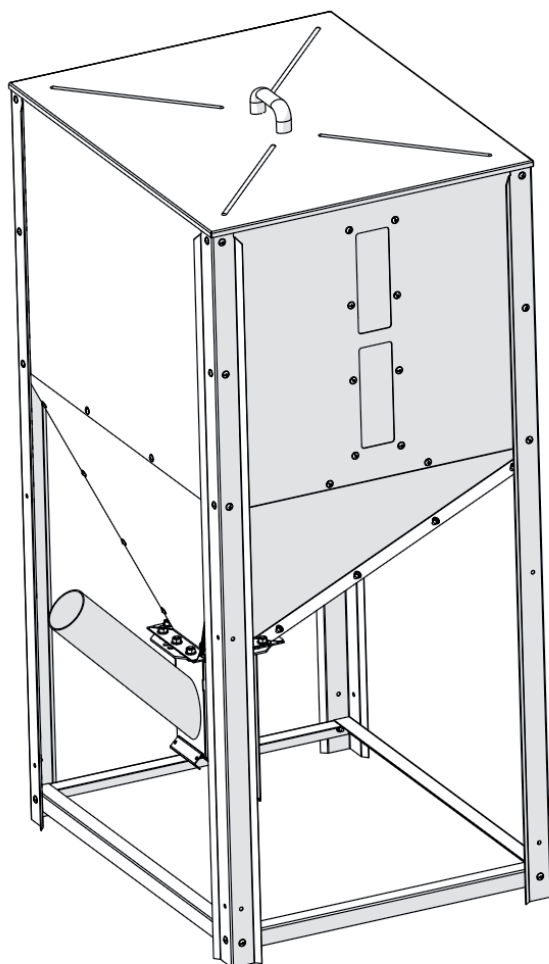

60 min

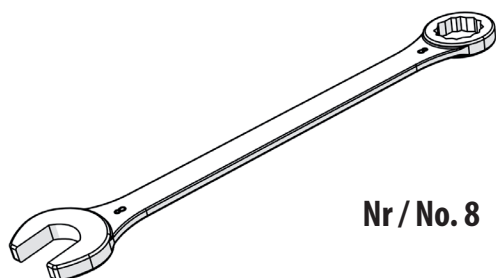

Nr / No. 8

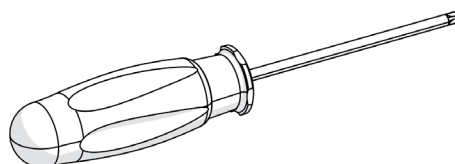

SL/PZ2

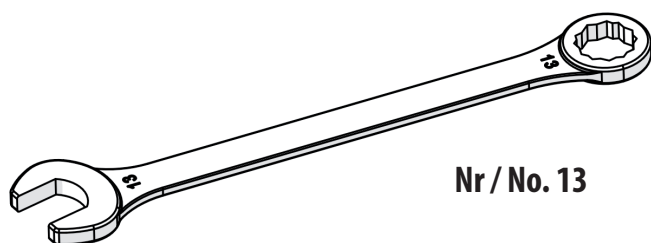

Nr / No. 13

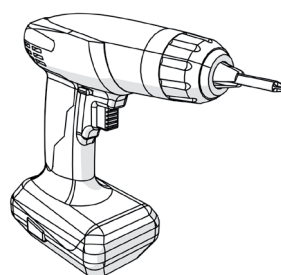

SL/PZ2

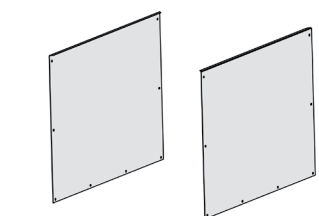
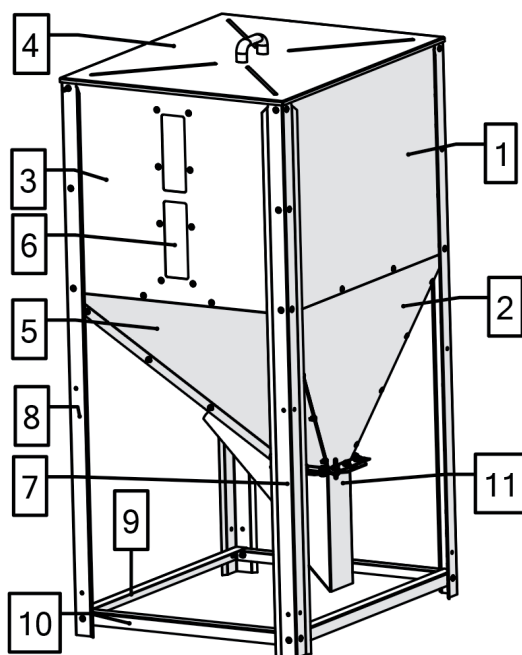
**Nr / No. 1**

1 szt. (L+P) / pc

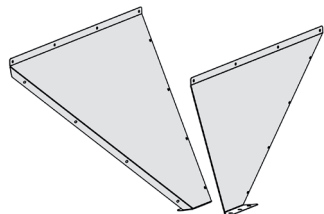
**Nr / No. 2**

1 szt. (L+P) / pc

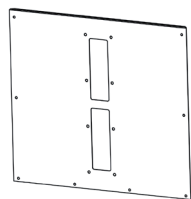
**Nr / No. 3**

1 szt. / pc

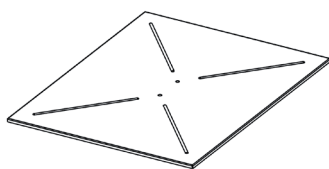
**Nr / No. 4**

1 szt. / pc

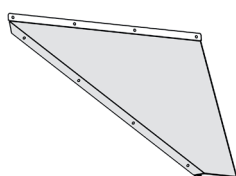
**Nr / No. 5**

1 szt. / pc

**Nr / No. 6**

1 szt. / pc

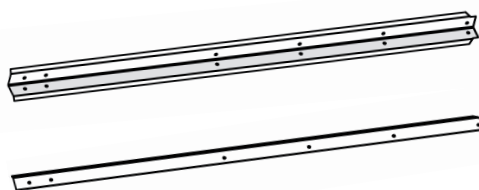
**Nr / No. 7**

2 szt. / pcs

Nr / No. 8

2 szt. / pcs

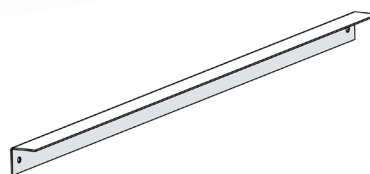
**Nr / No. 9**

2 szt. / pcs

**Nr / No. 10**

2 szt. / pcs

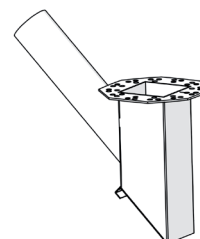
**Nr / No. 11**

1 szt. / pc

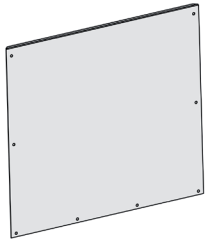
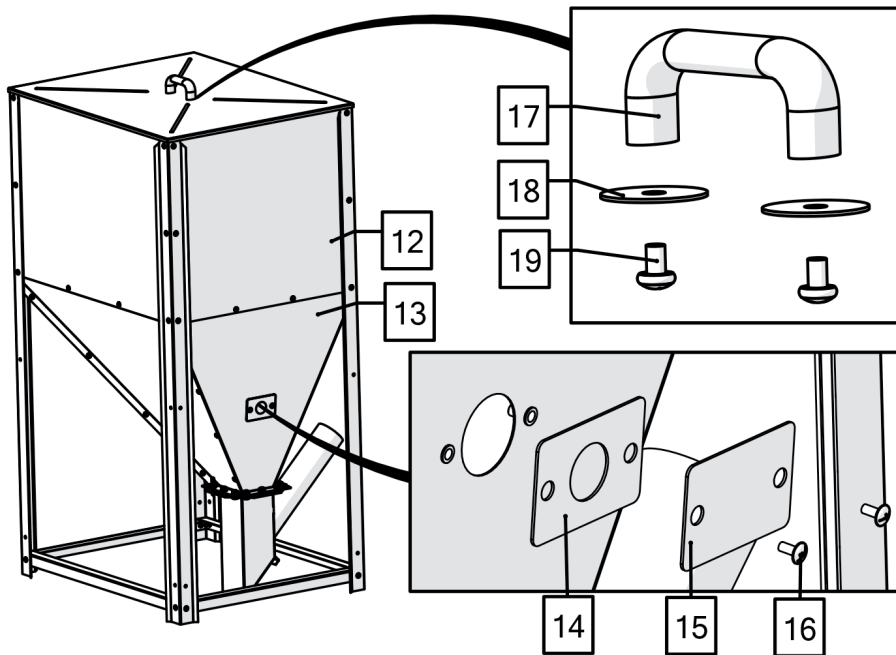

Nr / No. 12
1 szt. / pc

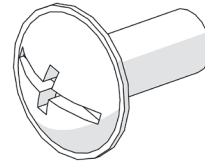

Nr / No. 16
66 szt. / pcs

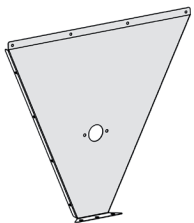

Nr / No. 13
1 szt. / pc

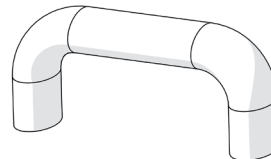

Nr / No. 17
1 szt. / pc

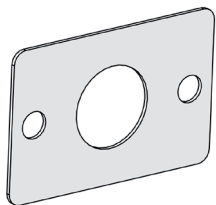

Nr / No. 14
1 szt. / pc

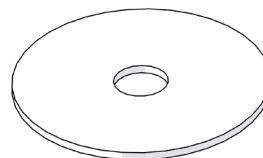

Nr / No. 18
2 szt. / pcs

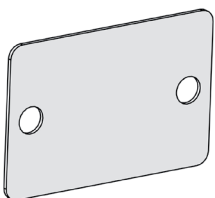

Nr / No. 15
1 szt. / pc

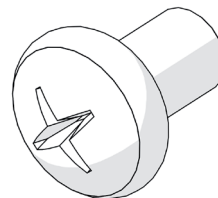

Nr / No. 19
2 szt. / pcs

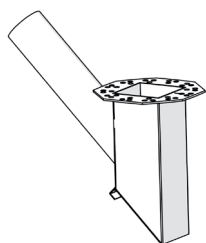
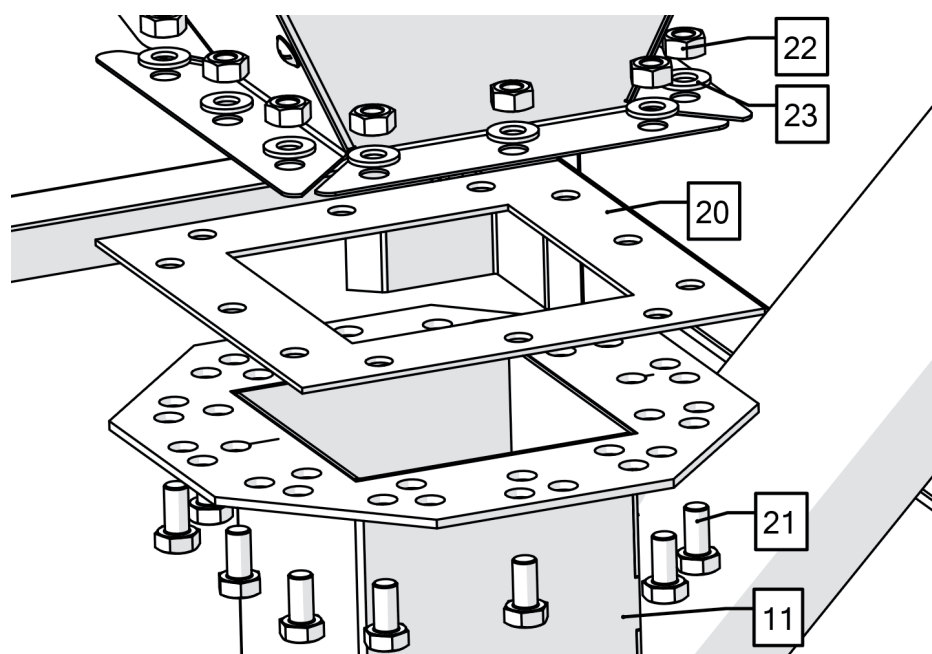
**Nr / No. 11**

1 szt. / pc

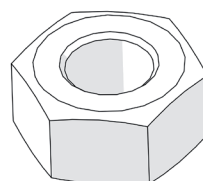
**Nr / No. 22**

12 szt. / pcs

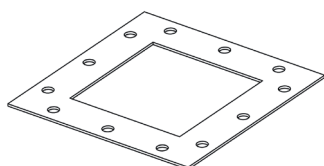
**Nr / No. 20**

1 szt. / pc

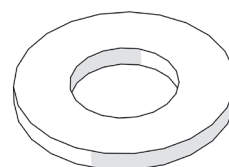
**Nr / No. 23**

12 szt. / pcs

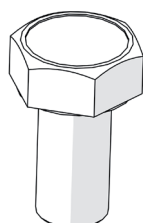
**Nr / No. 21**

12 szt. / pcs

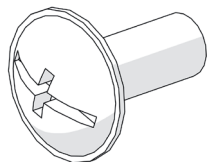
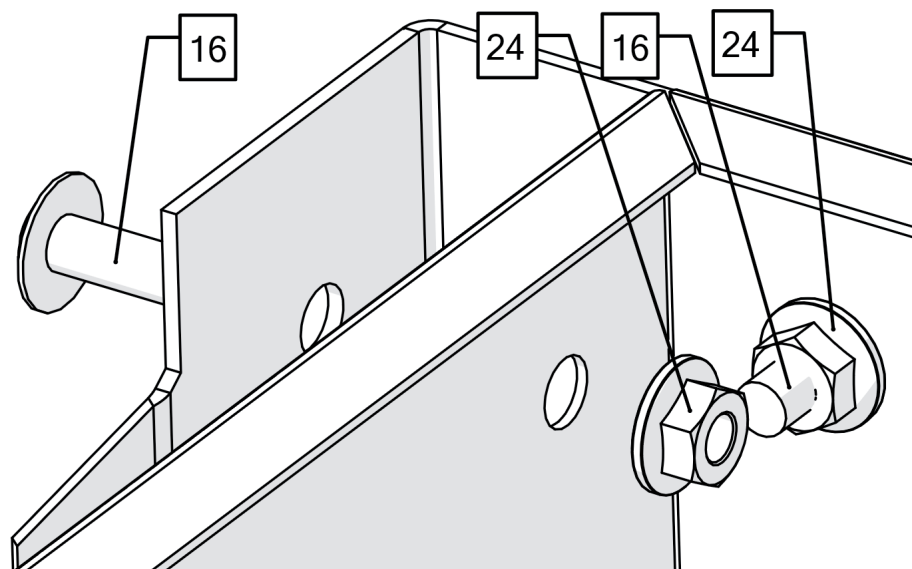

Nr / No. 16
66 szt. / pcs

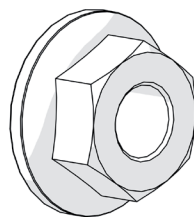

Nr / No. 24
64 szt. / pcs

KOSTRZEWA®
Ogrzewanie i wentylacja



Kraina Wielkich
Jezior
Mazurskich
The Great Masurian Lake district

Kontakt | Contact us

P.P.H. Kostrzewa Sp.J.

11-500 Giżycko
ul. Przemysłowa 1
Polska / Poland

tel. / phone: +48 87 429 56 00

tel. / phone: +48 87 428 53 51

www.kostrzewa.com.pl